

Township N^o 3 North, Range N^o 7 West, San Bernardino Meridian.

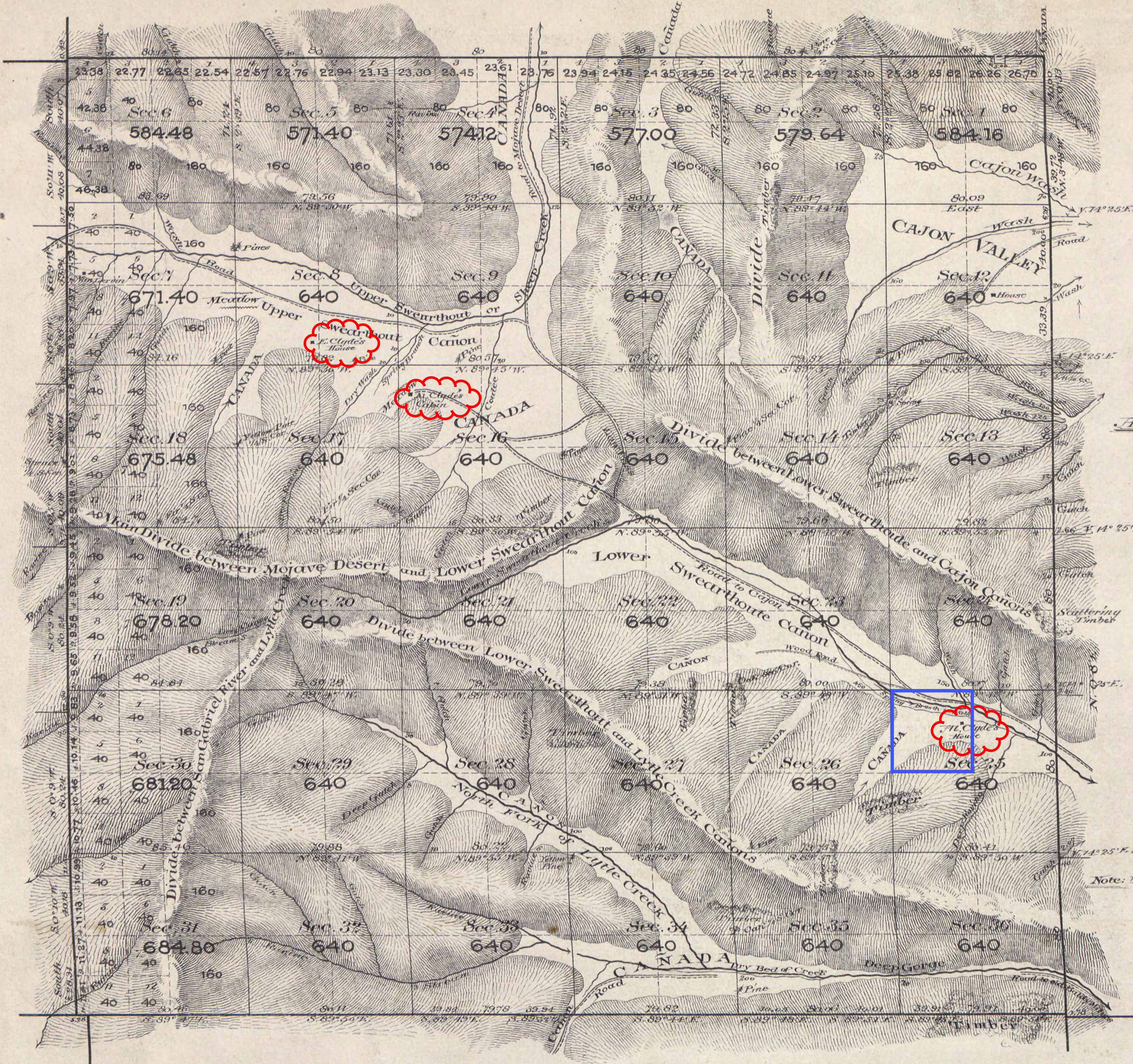

RECEIVED WITH
SUR. GEN'L'S LETTER
NOV 13 1885

Aggregate Area of Public Land 2,861.88 Acres.

Note: The Magnetic Declination is 14° 20' E., except where otherwise marked.

Surveys designated	By whom surveyed	Date of Contract	Amount of Surveys	When surveyed	Mean Declin ⁿ
Part of E. Boundary of Township	Henry Hancock	February 15 th 1855		1855	
North half of W. "	William Minto	May 26 th 1882		1882	
S. "	G. W. Pearson	December 10 th 1883		1884	
S. "	J. R. Glover	January 14 th 1884		1884	
Township Boundaries re-surveyed	G. H. Ferrin	December 24 th 1884	13 Mts. 63 Chs. 39 Lhs.	1885	
Rest of Township Boundaries	"	"	10 " 4 " 45 "	"	14° 22' East.
Section lines	"	"	59 " 61 " 18 "	"	
Connecting lines	"	"	0 " 55 " 70 "	May 9 th 1885	

The above Map of Township N^o 3 North, Range N^o 7 West, San Bernardino Meridian, is strictly conformable to the field notes of the surveys thereof, on file in this Office, which have been examined and approved.
U.S. Surveyor General's Office
San Francisco, California
November 13th 1885

W.H. Brown
U.S. Surv. Gen'l. Cal.

Posted July 14, 1894,
P.H.S.